

COLOURLINE GRAZE

Interior RGBW Luminaire



SPECIFICATIONS	
color temperature	RGBW / Tunable White
PHYSICAL	
beam spread	12° x 12°, 15° x 30°, 20° x 10°, 20° x 40°, 25° x 25°, 30° x 60°, 40° x 15°, 40° x 40°
LEDs per foot	(RGBW 4 in 1 multichip) - 10 per foot
weight	1 foot (.9 lbs), 4 foot (3.6 lbs)
housing	anodized extruded aluminum housing with injection molded polycarbonate end caps
lens	clear polycarbonate
mounting	standard surface mount bracket with full 180° rotation (+/- 90° from center)
ingress protection	dry or damp locations IP43 rated
luminaire connections	daisy chain with male and female, 5-PIN connectors
PERFORMANCE	
lumen output [all on]	525 lm per foot (14W) / 350 lm per foot (9W) / 185 lm per foot (5W) @ 100% all colors
lumen maintenance	L70 > 70,000 hours
CCT Modes	dynamic white (2000K–6500K) color tuning range can be custom set at factory
operating temperature	-4°F to 104°F (-20°C to 40°C)
protocols	DMX 512, RDM (ANSI E1.20)
ColourQuick (CQ)	provides uniform beam saturation, instantaneously without scalloping
ColourClone (CC)	manufacturing process uses robotic systems to provide 1 SDCM like consistency between luminaires by calibrating every luminaire to the same exact X, Y, chromaticity coordinates
ColourSoft (CS)	embedded firmware enables 16-bit resolution using only 8-bits of data to enhance the low trim curve for no-flicker at the slowest transition speeds
ColourMode (CM)	RGBW and Tunable White in one luminaire using 6 DMX channels Channels 1-4 - RGBW, Channels 5-6* - Tunable White (channel 5 = intensity and channel 6 = CCT) <i>*Tunable White mode must use the entire luminaire as one unit</i>
warranty	5-Year limited warranty
ELECTRICAL	
input voltage	Universal 120 - 277 VAC
power supply	integral Class II, electronic high-power factor 99% @ 120V
controls	SSL color controller, 3rd party DMX 512, RDM standard based control systems
certification	ETL / cETL, FCC-Part 15
standards	UL-Class I
power consumption	1 ft @ full power (13W / 9W / 5.5W), 4 ft @ full power (52W / 36W / 20W)

Ordering Information

PART NUMBER

SSL-CLGR						
MODEL	LENGTH	COLOR	OUTPUT	OPTICS	OPTIONS (CHOOSE 1)	
SSL-CLGR	COLOURLINE GRAZE	1 12 in. [305 mm]	RGBW RGBW	14W 14W/ft	12 12° x 12° beam	CGL-1 ColourLine Graze Louver - 1ft
		4 48 in. [1219 mm]	RGBW-TW RGBW & Tunable White	9W 9W/ft	1530 15° x 30° beam	CGL-4 ColourLine Graze Louver - 4ft
			TW Tunable White	5W 5W/ft	2010 20° x 10° beam	CGHS-1 Louver w/House Shield - 1ft
					2040 20° x 40° beam	CGHS-4 Louver w/House Shield - 4ft
					25 25° x 25° beam	*Louver & House Shield not recommended for
					3060 30° x 60° beam	10° x 40°, 30° x 60°, 40° x 15°, 40°, 60° x 20°
				4015 40° x 15° beam		
				40 40° x 40° beam		

Cable Accessories (order separately)

REQUIRED: Each linear run requires a Starter Cable and Terminator Cap. See page 7 for maximum run length.

_____ SCM10CL 10 ft. Starter Cord	_____ TCAPDCL Data Terminator Cap (w/ 120 ohm resistor)	_____ EC12-10V 12 in. Extension Cord
_____ SCM25CL 25 ft. Starter Cord	_____ DB10CL 10 ft. Data Bridge Cable	_____ EC24-10V 24 in. Extension Cord
	_____ DB25CL 25 ft. Data Bridge Cable	_____ EC60-10V 60 in. Extension Cord
		_____ EC120CL 10 ft. Extension Cord

Mounting Options (order separately)

	Luminaire	CA2 Requirement per luminaire
_____ CA2-6 Cantilever Arm - 6"	1-foot	1
_____ CA2-12 Cantilever Arm - 12"	4-foot	2
_____ CA2-18 Cantilever Arm - 18"		

_____ PHAROS TPS-5-B 5" Designer Touch Panel Station	_____ CSC-E ColourSelect Controller (2 universe)
_____ PHAROS XPC1 Expert Controller; 512 channels of eDMX/DMX	_____ DE3BK(WH) Nicolaudie STICK DE-3 Black or White Wall Mount Controller w/color dial
_____ PHAROS XPC2 Expert Controller; 1024 channels of eDMX/DMX	_____ CW4-WH Nicolaudie STICK White Touch Screen with Internal WiFi
_____ PHAROS XPT-5-B Expert Touch Panel; 5" Display in Black	_____ GA2WH(BK) Nicolaudie STICK-GA2 White or Black Wall Mount Controller
_____ PHAROS TPC-BB Touch Panel Controller - Black on Black (512 Channels EDMX)	_____ DXC-25 25 foot DMX cable
_____ PHAROS EXT Extension for TPC Connectivity	_____ DXC-50 50 foot DMX cable
_____ PHAROS LPC1 Lighting Playback Controller 1 (512 channels DMX/eDMX)	_____ DXC-100 100 foot DMX cable
_____ PHAROS LPC2 Lighting Playback Controller 2 (1,024 channels DMX/eDMX)	_____ CD-10 10 foot controller data cable (for CSC only)
_____ PDX2 Power Data Wiring Box (exterior rated)	_____ CD-25 25 foot controller data cable (for CSC only)
_____ PDX-RDS2 Power Data Wiring Box w/2-port splitter	_____ CD-50 50 foot controller data cable (for CSC only)
_____ PDX-RDS4 Power Data Wiring Box w/4-port splitter	_____ CD-100 100 foot controller data cable (for CSC only)
_____ CL-RS4 4 Port RDM splitter w/120V power supply	_____ MV 5900 Multiverse Show Baby DMX Wireless Bridge (Indoor)
_____ SCSC-2WH (2BK) White or Black Wall Mount ColourSelect Controller (2 universe)	_____ 7400-5707M Show DMX Vero DMX Wireless Bridge (Exterior)

Controller Data Cables/DMX Cables listed are exterior rated cables.
(Belden 3105A or equivalent) CD-XX cables have male XLR at one end.



Dimensions

ColourLine Graze

DIMENSIONS WITH STANDARD BRACKET

luminaire length 1' and 4'
H = 12" (1') and 48" (4')

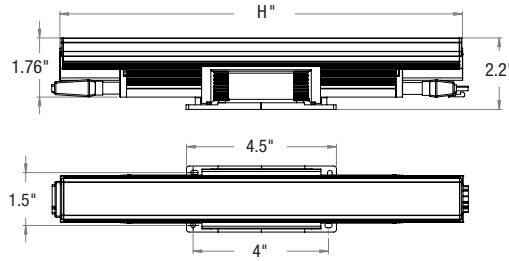
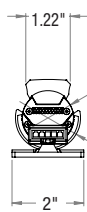

Standard 180° Adjustable Bracket

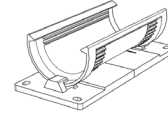

180° Full Rotation

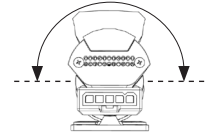

Photometry

CLGR 1FT RGBW

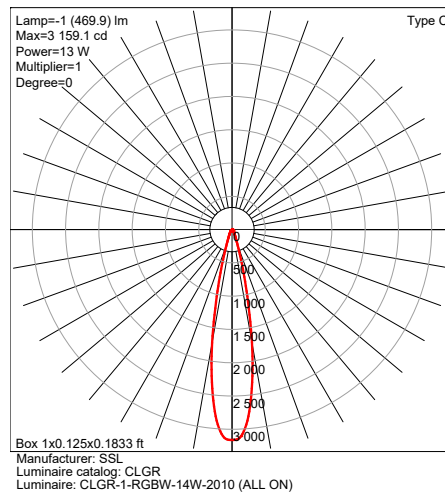
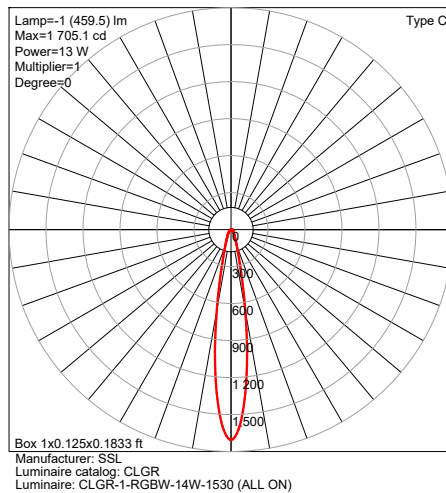
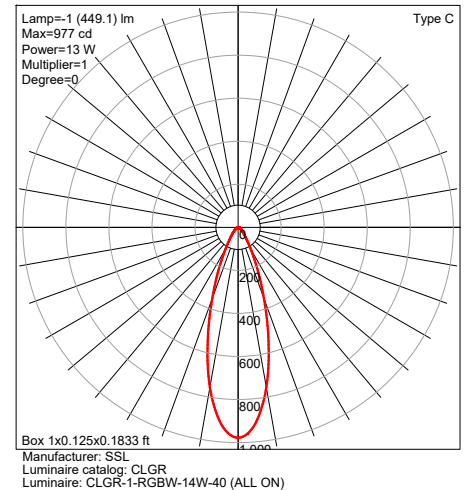
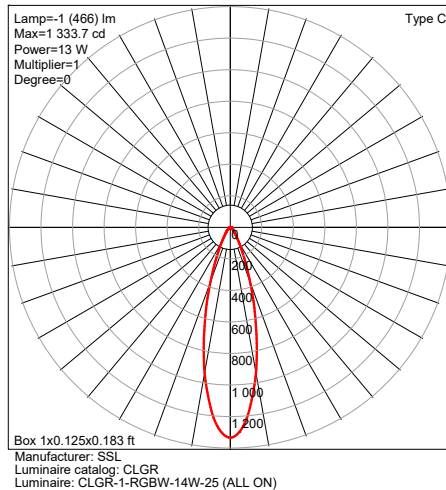
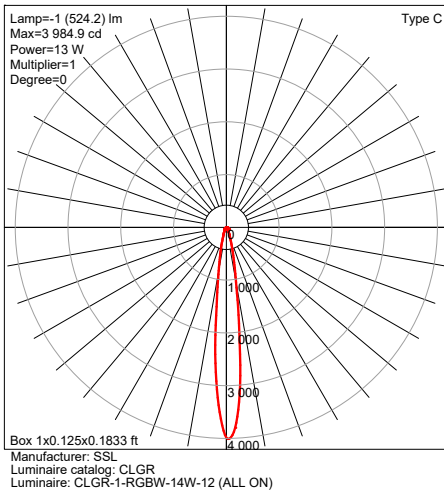

CLGR 1FT RGBW

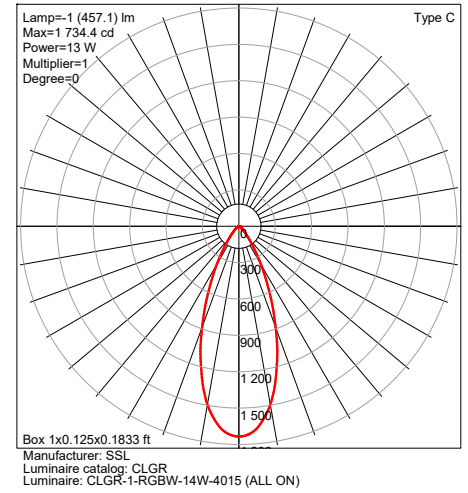
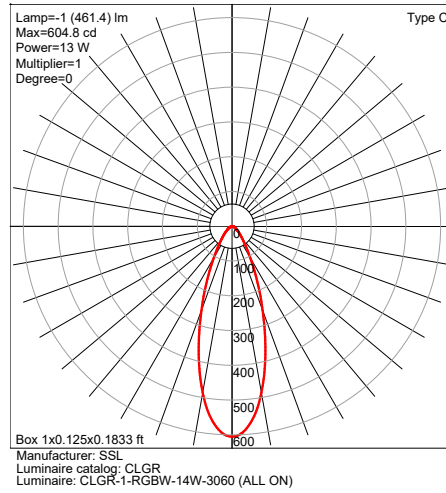
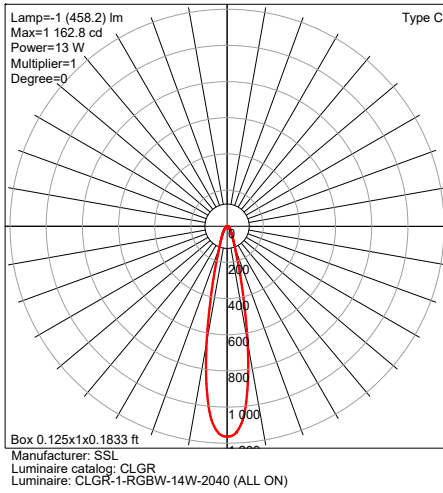

SPECTRAL INFORMATION

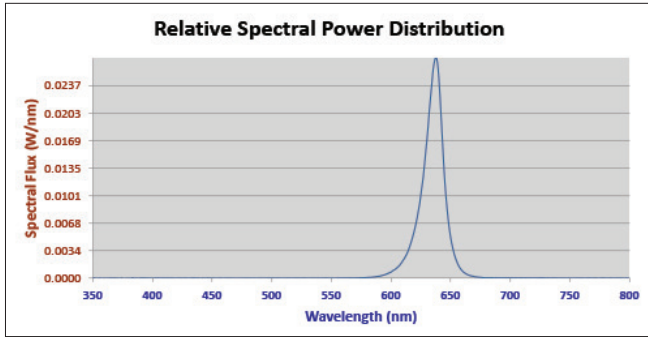

RED	
Dominant Wavelength	625
Peak Wavelength	637
Chromaticity Difference	N/A

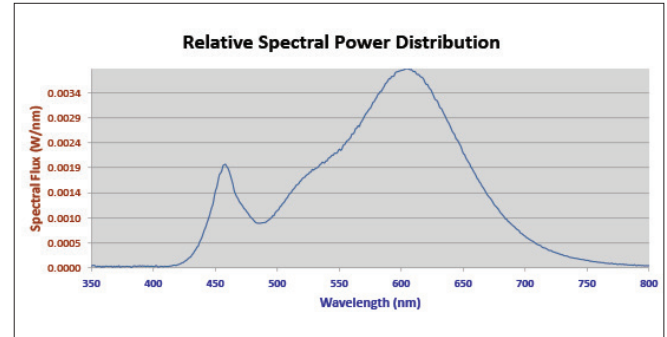

WHITE	
Dominant Wavelength	583
Peak Wavelength	604
Chromaticity Difference	0.0009
CCT	2985K

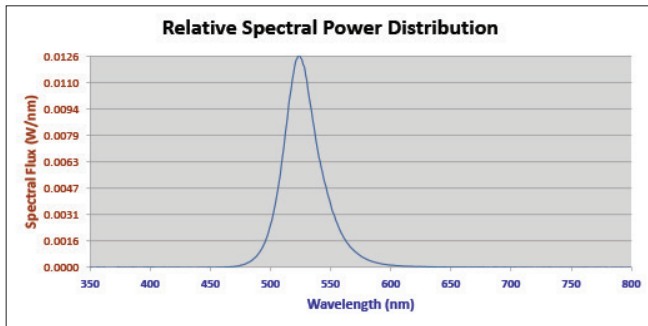

GREEN	
Dominant Wavelength	530
Peak Wavelength	524
Chromaticity Difference	0.1537

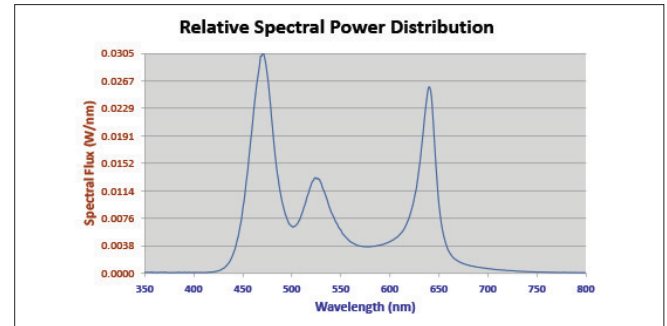

ALL ON	
Dominant Wavelength	477
Peak Wavelength	470
Chromaticity Difference	-0.003

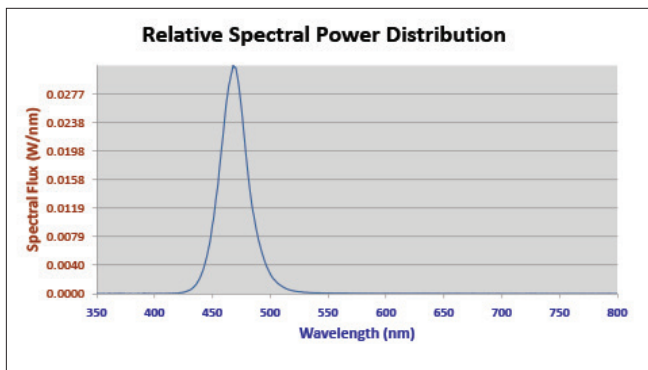

BLUE	
Dominant Wavelength	471
Peak Wavelength	469
Chromaticity Difference	0.1619

Due to continuous development and improvements, specifications are subject to change without notice.
Product use certifies agreement to Solid State Luminaires terms and conditions.

CANTILEVER ARM (CA2) - Available in 3 Lengths

CA2	arm length	Luminaire	CA2 Requirement
CA2-6	6"	1-foot	1
CA2-12	12"	4-foot	2
CA2-18	18"		

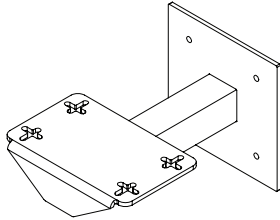

ISOMETRIC VIEW

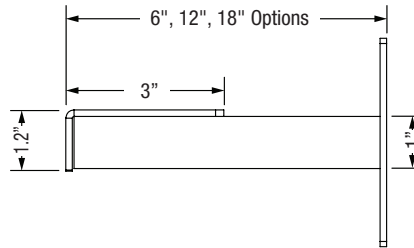

SIDE VIEW

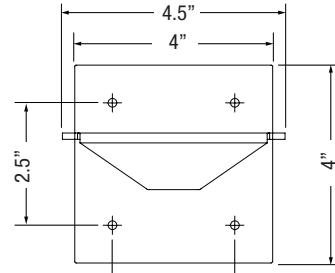

FRONT VIEW

LOUVER (CGL)

	(A) louver length
CGL-1	12"
CGL-4	48"

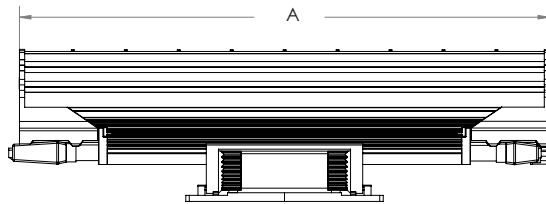
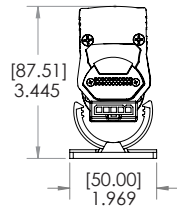
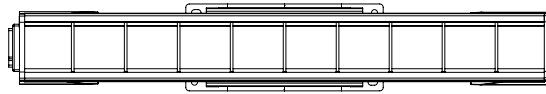

LOUVER with HOUSE SHIELD (CGHS)

	(A) louver length
CGHS-1	12"
CGHS-4	48"

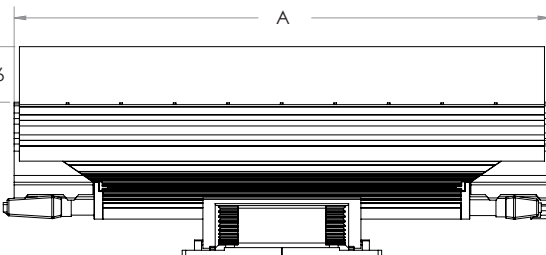
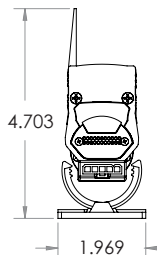
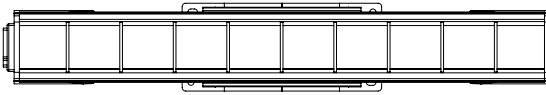

CONNECTIONS & CABLES

LINEAR LIGHTING RUN

Male / Female connectors on luminaires are used to make linear lighting runs by being connected End-to-End, to create an even linear light pattern.



GAP BETWEEN CONNECTED LUMINAIRES

Luminaires connect closely together to ensure runs have an even linear light pattern.

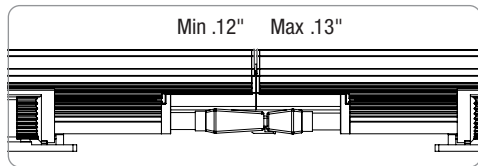

TERMINATOR CAP (TCAPDCL)

Required Terminator Cap is used at the end of each linear lighting run.

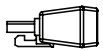

Data Terminator Cap
(w/ 120 ohm resistor)

STARTER CORD (SCM10/25CL)

Required Starter Cord comes in multiple lengths with a luminaire connector at one end and lead wires at the other end for connecting power & data.

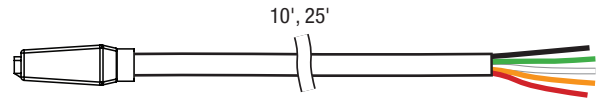

EXTENSION CORD (ECxx-10V) or (EC120CL)

The Extension Cord comes in multiple lengths with a luminaire connection at each end for power & data and adding space between luminaires in a linear run.

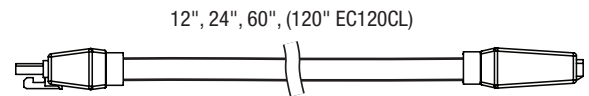

DATA BRIDGE CABLE (DBxxCL)

Provides continuation of DMX Data only, from the end of one run to the PDX box of the next run. Luminaire connection at one end and lead wires at the other.

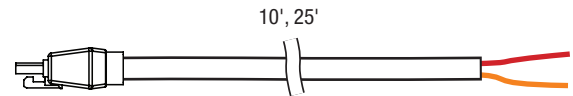

CLGR - SINGLE SEGMENT CONFIGURATION EXAMPLE

Max Run Lengths	120V	240V	277V
14W luminaire	48'	94'	108'
9W luminaire	72'	146'	169'
5W luminaire	72'	146'	169'

May add up to 50 feet of Extension or Starter Cord to above.

Component Identification

- 1) DMX Color Controller (see pg. 2)
- 2) DMX Data Cable **DXC-xx** or **CD-xx** (CSC only)
- 3) PDX Power Data Wiring Box
- 4) Starter Cord **SCMxxCL**
- 5) First luminaire begins Linear Run
- 6) Luminaires connect end to end
- 7) Distance from 1st to last luminaire in linear run
- 8) Extension Cord **ECxx-10V** or **EC120CL**
(Can add up to 50' more Extension Cord to Max Run Length)
- 9) Last luminaire in the linear run
- 10) Terminator Cap **TCAPDCL** (required at end of run)
- 11) Last luminaire showing Data Bridge Cable connection
- 12) Data Bridge Cable **DBxxCL** to continue DMX Data only
- 13) PDX Box to connect Data Bridge Cable
- 14) Continuation of controlled luminaire run

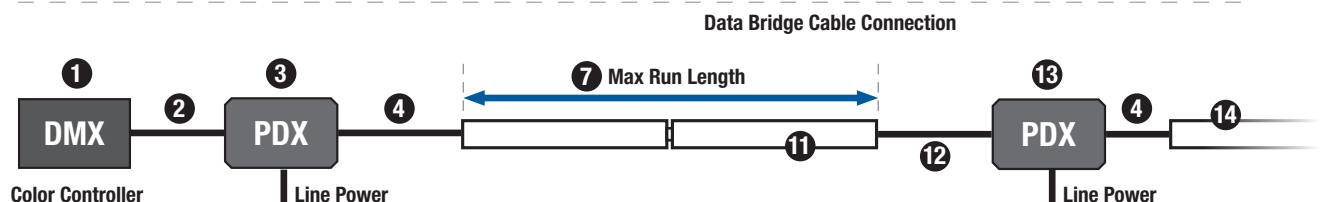
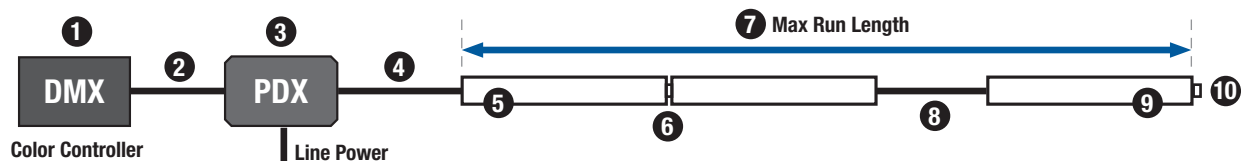

PERSONALITY - SET AT FACTORY FOR SPECIFIC CAPABILITIES

Consult factory when ordering to establish requirements for personality assignment and other addressing or feature programming to suit application specifics.

Personality 1 4 foot & 1 foot luminaires **configured 4 Channels per luminaire** (R,G,B,W)



Personality 2 4 foot & 1 foot luminaires **configured 2 channels per luminaire** (Color Tuning / Dynamic White) (No RGBW)



Personality 3 4 foot & 1 foot luminaires **configured 6 Channels per luminaire** to support **Digital Dual Mode 6-Channel DMX** (Channel 1-4 RGBW, 5-Brightness, 6-Tunable White CCT)

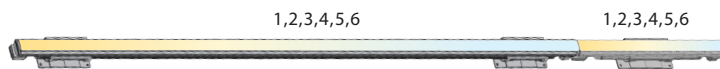

Personality 4 4 foot luminaire (only) **configured in 2 foot increments** (4 Channels/2ft - R,G,B,W)



Personality 5 4 foot luminaire (only) **configured in 1 foot increments** (4 Channels/1ft - R,G,B,W)



PDX2 - POWER DATA WIRING BOX (ONE PDX2 REQUIRED PER RUN)

The PDX2 is an exterior-rated enclosure that consolidates multiple input sources into one output to the CLGR luminaires. Data input from the RDM Color controller and AC input combine to provide one output to a Starter Cord. One PDX2 box is required per each luminaire run.

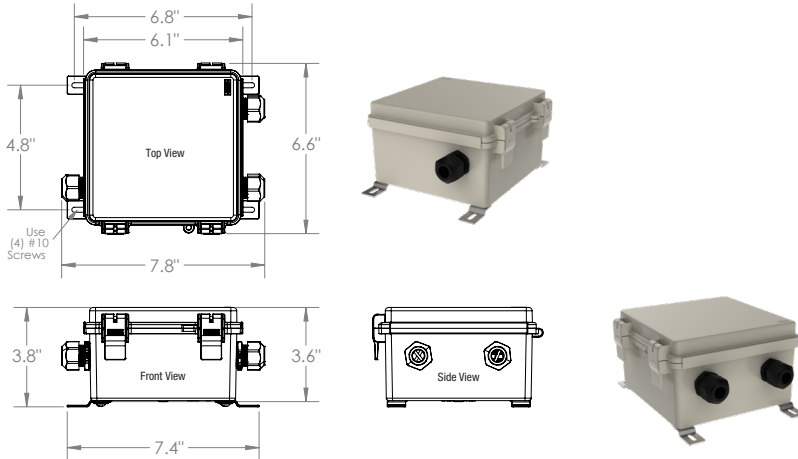

PDX2 Wiring for ColourLine Series

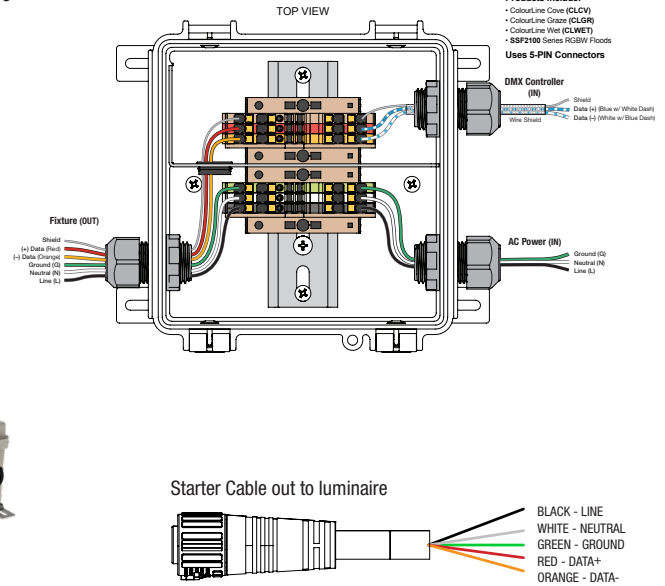

PDX-RDS2 - POWER DATA WIRING BOX - WITH 2-PORT SPLITTER

The PDX-RDS2 is an exterior-rated enclosure with a transparent, hinged cover that latches and seals using a formed in place PUR gasket and a stainless steel hinge pin. The PDX-RDS2 houses a DMX/RDM 2 port splitter/repeater that takes in one DMX input and provides two regenerated DMX outputs that can be any combination of starter cords or straight DMX outputs. The repeater allows you to daisy-chain PDX2 or PDX-RDS2 boxes by providing two maximum DMX run length outputs.

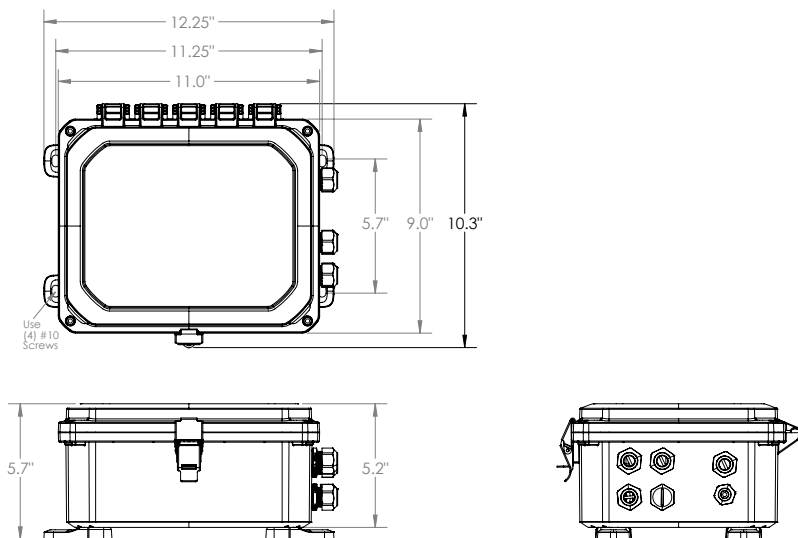

Connector Identification

- 1) AC Input (Line power)
- 2) DMX Data Cable **DXC-xx** or **CD-xx** (CSC only)
- 3) Starter Cord **SCxxLZWET** one
- 4) Starter Cord **SCxxLZWET** two
- 5) Auxiliary Ground



DMX / RDM PROTOCOL CONTROLLERS



PHAROS TPC-BB - Pharos Touch Panel Controller - Black on Black Finish

TPC Touch Panel Controller is an elegant lighting controller with a customizable 4.3" touch screen, 512 channels of eDMX output and flexible interfacing potential. The TPC must work in conjunction with the EXT or LPC. Pharos Backbox is available for mounting.



PHAROS EXT - Extension Device for TPC Connectivity

The Pharos EXT is an extension for the Pharos TPC for making the physical DMX or eDMX output connections. It also provides a PoE connection for the TPC. It's DIN rail mounted. This device supports electrical input of 120-240V AC power.



PHAROS LPC - Lighting Playback Controller

Pharos offers two playback controllers, LPC1 (512 channels DMX/eDMX) and LPC2 (1024 channels DMX/eDMX) Pharos LPC (Lighting Playback Controller) is a versatile control solution. The LPC family features individually controllable and independently running timelines and scenes, letting you build dynamic, precise, fully customizable lighting effects. The LPC can be ordered with 1 to 100 Universe capability. It requires a TPC or PC to interface and is powered via 9V to 48V DC or PoE (IEEE802.3af, Class 2), 4W typical.



DE3BK(WH) - Nicolaudie STICK-DE3 Black or White Wall Mount Controller with Color Dial

STICK DE3 provides an elegant solution to controlling your DMX fixtures. The glass, touch-sensitive panel can be used in multiple ways to select a programmed scene, change a color attribute or directly select a color from the color wheel. Scenes are displayed on the graphical color display. The DE3 provides 1024 DMX Channels with up to 500 scenes and 10 separate zones can be created and controlled separately. 120 VAC is required for operation. The DE3 is programmed via Nicolaudie's ESA2 or ESA PRO software. Programs are stored on the internal MicroSD card.

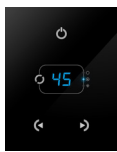

CW4-WH - Nicolaudie STICK CW4 White Touch Screen with Internal WiFi CW4 touch controller provides 1024 channels of control. 36 scenes can be created in 1 zone. An internal access point provides remote control via any WiFi device using the Lightpad app from Nicolaudie.

GA2BK(WH) - Nicolaudie STICK-GA2 Black or White Wall Mount Controller

GA2 is an economical controller with glass, touch-sensitive screen for basic control of up to 99 scenes and 1 available zone. It can control 512 DMX Channels. An LED display makes it easy to determine which scene number is playing.



CSC-E - SSL ColourSelect Controller

ColourSelect Controller 2 Universe provides (1024 Channels) of output data capable of controlling 5 zones independently. CSC-E has two 3-pin female XLR connectors to connect to your DMX network and is defaulted in splitter mode, so two separate runs can be connected and controlled. It can store a total of 80 programmable presets. Additionally buttons control speed, dimming, scenes and static colors. The CSC can be powered via a PC USB port or with the PS-CSC external 120V AC power supply included.



SCSC-2WH (or 2BK) - SLIM White ColourSelect Controller Wall mount versions of the CSC-E, includes power supply.